

BOROUGH OF Newtown

Office of the Borough Engineer

CKS Engineers – 4259 W. Swamp Road, Suite 410, Doylestown, PA 18902 - 215-340-0600

Application for a Permit to Locate, Construct or Alter Driveway and Frontage (Sidewalk and/or Curb) and/or Improvement to Storm Drainage Facilities located Within the Right-of- Way of a Street In the Borough of Newtown

PLEASE PROVIDE THREE (3) COPIES OF APPLICATION AND PROJECT SKETCH PLAN (See GENERAL INSTRUCTIONS on back of this form)

SECTION I – GENERAL INFORMATION

DATE: _____ RESIDENTIAL _____ NON-RESIDENTIAL _____ TAX MAP PARCEL #: _____

Property Address of Proposed Improvement(s) Project: _____

Property Owner Name: _____ Property Owner Phone #: _____

Property Owner Mailing Address: _____

Applicant Name (if different from owner): _____ Applicant Phone #: _____

Applicant Address: _____

Contractor Name: _____ Contractor Phone #: _____

Contractor Address: _____

Owner Signature: _____ Date: _____ Applicant Signature: _____ Date: _____

SECTION II – NATURE OF CONSTRUCTION/ALTERATION/IMPROVEMENT PROJECT

Description and Purpose of Work Related to the Project: _____

Signature of Applicant _____ Date _____ Signature of Owner (If different) _____ Date _____

SECTION III – PERMIT for FRONTAGE IMPROVEMENT (to be completed by Newtown Borough Engineer)

PERMIT #: _____ DATE ISSUED: _____

PERMIT FEE: \$ _____ CHECK #: _____ ESCROW (if required): \$ _____ CHECK #: _____

Permission has been granted to the above to locate, construct, or alter Driveway and Frontage (Sidewalk and/or Curb) and/or Storm Drainage Facilities on the premises as set forth above and in accordance with this permit, the accompanying approved plans and the provisions of the applicable Borough ordinance(s).

BOROUGH ENGINEER: _____ DATE OF APPROVAL: _____

SECTION IV – FINAL INSPECTION APPROVAL OF COMPLETED PROJECT

BOROUGH ENGINEER: _____ DATE OF APPROVAL: _____

GENERAL INSTRUCTIONS

Any work within the Right-of-Way of a Borough street relating to the location, construction or alteration of a driveway or frontage (Sidewalk and/or Curb) and/or storm water facilities requires the submission of three (3) copies of this form, along with three (3) copies of a sketch plan showing the location and details of the proposed project.

Complete SECTION I of the application in its entirety, providing enough information to adequately indicate the specific location of the proposed project.

Complete SECTION II of the application with an adequately descriptive statement relative to the work to be done, the materials to be used, and any peculiarities inherent to the project. The accompanying sketch plan should include, but not be limited to, the following: accurate location of any existing storm water facilities; accurate location of existing features such as edge of road, existing curb and sidewalk, and existing utility poles and trees. Proposed construction features should be shown and adequately dimensioned, indicating the type of materials and limits of improvements.

After issuance of a Frontage Improvement Permit by the Borough Engineer (SECTION III), the applicant and/or the contractor doing the work is required to notify the Borough Engineer at least forty-eight (48) hours before any work is started in connection with any improvements that are to be made.

Upon completion of the project, a Final Inspection (SECTION IV) is required. The applicant and/or the contractor doing the work is required to notify the Borough Engineer that the work is completed and ready for a final inspection.

BOROUGH OF NEWTOWN

ORDINANCE NO. 716

AN ORDINANCE OF NEWTOWN BOROUGH, BUCKS COUNTY, PENNSYLVANIA, AMENDING THE CODE OF THE BOROUGH OF NEWTOWN AND THE NEWTOWN BOROUGH SUBDIVISION AND LAND DEVELOPMENT ORDINANCE BY MODIFYING THE DESIGN STANDARDS AND REQUIREMENTS FOR CONSTRUCTION, REPAIR OR REPLACEMENT OF SIDEWALKS LOCATED IN THE BOROUGH, PERMITTING POSTS AND BOLLARDS TO BE INSTALLED ADJACENT TO SIDEWALKS UPON SATISFACTION OF REQUIRED CONDITIONS AND PROVIDING FOR THE MAINTENANCE OF POSTS AND BOLLARDS BY PROPERTY OWNERS.

WHEREAS, by Ordinance No. 519, as amended, the Council of Newtown Borough, Bucks County, Pennsylvania ("Council") enacted a Subdivision and Land Development Ordinance ("SALDO") pursuant to its statutory authority, the Pennsylvania Municipalities Planning Code, 53 P.S. §10101, et seq. ("MPC), as amended;

WHEREAS, by Ordinance No. 420, as amended, Council enacted an Ordinance governing Sidewalks and Curbs located in the Borough (the "Sidewalk Ordinance") pursuant to its statutory authority, Section 1202(17) of the Pennsylvania Borough Code, 53 P.S. §45101, et seq., as amended;

WHEREAS, through careful study and consideration, Council has determined that certain provisions of the SALDO and the Sidewalk Ordinance should be amended to address changed requirements and design standards adopted by the Pennsylvania Department of Transportation in connection with efforts to comply with the Americans with Disabilities Act; and

WHEREAS, Council has further determined that the Sidewalk Ordinance should be further amended to allow the installation of posts and bollards upon the satisfaction of certain requirements.

NOW, THEREFORE, the Council of Newtown Borough, Bucks County, Pennsylvania does hereby enact and ordain the following:

SECTION 1. Section 501(F) of the SALDO is amended by the addition of the following language at the end of the existing sentence:

“, and shall comply with all local, state and federal statutes, ordinances and regulations, including without limitation the Americans with Disabilities Act, as amended and PennDOT design standards and specifications, as amended.”

SECTION 2. The Subdivision and Land Development Ordinance of the Borough of Newtown is hereby amended by replacing the appendix pages titled “Typical Roadway Section,” “Cement Concrete Sidewalk,” “Clay or Concrete Brick Sidewalk, Bluestone Sidewalk,” “Typical Depressed Curb at Driveway,” “Plain Cement Concrete Curb” and “Typical Installation” with the pages attached to this Ordinance as Appendix “A” and such Appendix shall be labeled “Appendix ‘A’” in the SALDO.

SECTION 3. Section 507(C) of the SALDO is amended by deleting the existing language in its entirety and replacing it with the following:

Curbs shall be constructed in accordance with the design standards and specifications set forth in Appendix A of this Ordinance and shall further comply with any stricter requirements of any local, state and federal statutes, ordinances and regulations, including without limitation the Americans with Disabilities Act, as amended and PennDOT design standards and specifications, as amended.

SECTION 4. Section 509(D) of the SALDO is amended by the deletion of the first sentence and the insertion of the following in its place:

The materials to be used for sidewalks shall be determined on the basis of the sidewalk materials on adjacent properties and shall be standard finish concrete, blue stone, clay

brick, or concrete modular bricks matching the dimensions of clay brick. Concrete modular bricks shall be "through-colored" units emulating the color of natural brick.

SECTION 5. Section 509(F) of the SALDO is amended by the addition of the following language at the end of the existing section:

, and shall comply with all local, state and federal statutes, ordinances and regulations, including without limitation the Americans with Disabilities Act, as amended and PennDOT design standards and specifications, as amended.

SECTION 6. The Code of the Borough of Newtown is hereby amended by adding the following language at the end of Section 129-1.A:

All installation, construction and/or repair shall be performed in strict accordance with all applicable local, state and federal statutes, ordinances and regulations, including without limitation the Americans with Disabilities Act, as amended and PennDOT design standards and specifications, as amended.

For the purpose of Section 129-1 and its subsections, all references to public sidewalk(s) or curb(s) shall include sidewalks, curbs, curb ramps and driveway aprons.

SECTION 7. The Code of the Borough of Newtown is hereby amended by adding the following language at the end of Section 129-6.A:

All installation, construction and/or repair shall be performed in strict accordance with all applicable local, state and federal statutes, ordinances and regulations, including without limitation the Americans with Disabilities Act, as amended and PennDOT design standards and specifications, as amended.

For the purpose of Section 129-6 and its subsections, all references to public sidewalk(s) or curb(s) shall include sidewalks, curbs, curb ramps and driveway aprons.

SECTION 8. The Code of the Borough of Newtown is hereby amended by creating and adding Section 129-4.1 as follows:

Posts or bollards may be placed adjacent to a sidewalk if approved by Borough Council upon the satisfaction of the following conditions prior to construction and installation:

- A. A plan, drawn to scale, showing the proposed location and construction techniques shall be prepared and submitted to the Borough along with a narrative detailing the need for the posts or bollards.

- B. The proposed location and construction technique must be reviewed by and receive the approval of the Borough Engineer.
- C. The location of posts and bollards shall not block or impede pedestrian or wheeled traffic on the sidewalk.
- D. The location of posts and bollards shall not be within the public road clear zone in accordance with PennDOT Design Manual 2 (Pub.13M), AASHTO Green Book (A Policy on Geometric Design of Highway Standards) and AASHTO Roadside Design Guide, as amended.
- E. The property owner shall enter into an Agreement with the Borough, in a form satisfactory to the Borough Solicitor, that provides that (a) the post(s) or bollard(s) are owned by the property owner; (b) all maintenance responsibilities are those of the property owner; and (c) the property owner will indemnify and hold harmless the Borough from all claims, losses and liability in any way associated with the posts or bollards. The Agreement shall be in recordable form and shall be recorded, at the expense of the property owner, in the office of the Recorder of Deeds of Bucks County, Pennsylvania.
- F. The property owner shall reimburse the Borough for the fees of the Borough Engineer and Borough Solicitor and shall post an escrow in an amount as determined by Borough Council by resolution.
- G. Physical features of posts and bollards:
 - (1) Minimum side dimension or diameter - four (4) inches; maximum side dimension or diameter - eight (8) inches.
 - (2) Height above grade - thirty-six (36) inches to forty-two (42) inches.
 - (3) Externally-supplied electrical power for self-illumination shall not be permitted.
 - (4) Spacing between multiple posts and bollards shall be a minimum of forty-eight (48) inches.
 - (5) Chains connecting multiple posts and bollards and surface protrusions one (1) inch or greater shall not be permitted.
 - (6) Concrete-capped and filled galvanized steel pipe shall not be used for posts and bollards.
 - (7) All installation, construction and/ or repair shall be performed in strict accordance with all applicable local, state and federal ordinances, statutes and regulations, including without limitation, the Americans with

Disabilities Act, as amended, and Penn DOT design standards and specifications, as amended.

SECTION 9. The Code of the Borough of Newtown is hereby amended by adding the following language at the end of Section 129-1:

The owner or owners of any lot or lots in the Borough of Newtown upon which posts or bollards have been installed or placed shall maintain such posts or bollards in a safe and functional condition and shall immediately repair any defects in and around such posts or bollards, including but not limited to the obligation to repair holes, chips, cracks and dents and the obligation to paint or resurface a post or bollard that is worn, rusted or otherwise damaged. An existing post or bollard may not be removed without the approval of Borough Council.

SECTION 10. The Code of the Borough of Newtown is hereby amended by adding the following language at the end of Section 129-2:

Any and all repairs or other maintenance performed on posts and bollards as required by §129-1, above shall be in accordance with the original design and plan for the posts and bollards being repaired or maintained.

SECTION 11. Whenever the requirements of this Ordinance are in conflict with other requirements of the Ordinances of the Borough of Newtown, the most restrictive, or those imposing the higher standards, shall govern.

SECTION 12. The provisions of this Ordinance are severable. If any court of competent jurisdiction thereof shall hold any section, clause, sentence, part or provision illegal, invalid or unconstitutional, such decisions of the court shall not affect or impair any of the remaining sections, clauses, sentences, parts or provisions of this Ordinance. It is hereby declared to be the intent of the Council of the Borough of Newtown that this Ordinance would have been enacted if such illegal, invalid or unconstitutional section, clause, sentence, part or provision had not been included herein.

SECTION 13. This Ordinance shall become effective upon adoption by the Council of
Newtown Borough.

NEWTOWN BOROUGH COUNCIL

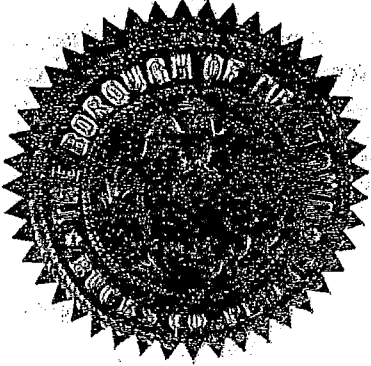

By: Julia Woldorf
Julia Woldorf, President

Attest: Marcia Scull
Marcia Scull, Secretary

Approved by Dennis O'Brien, Mayor

Dennis O'Brien
Dennis O'Brien, Mayor

Dated: 8/10/11

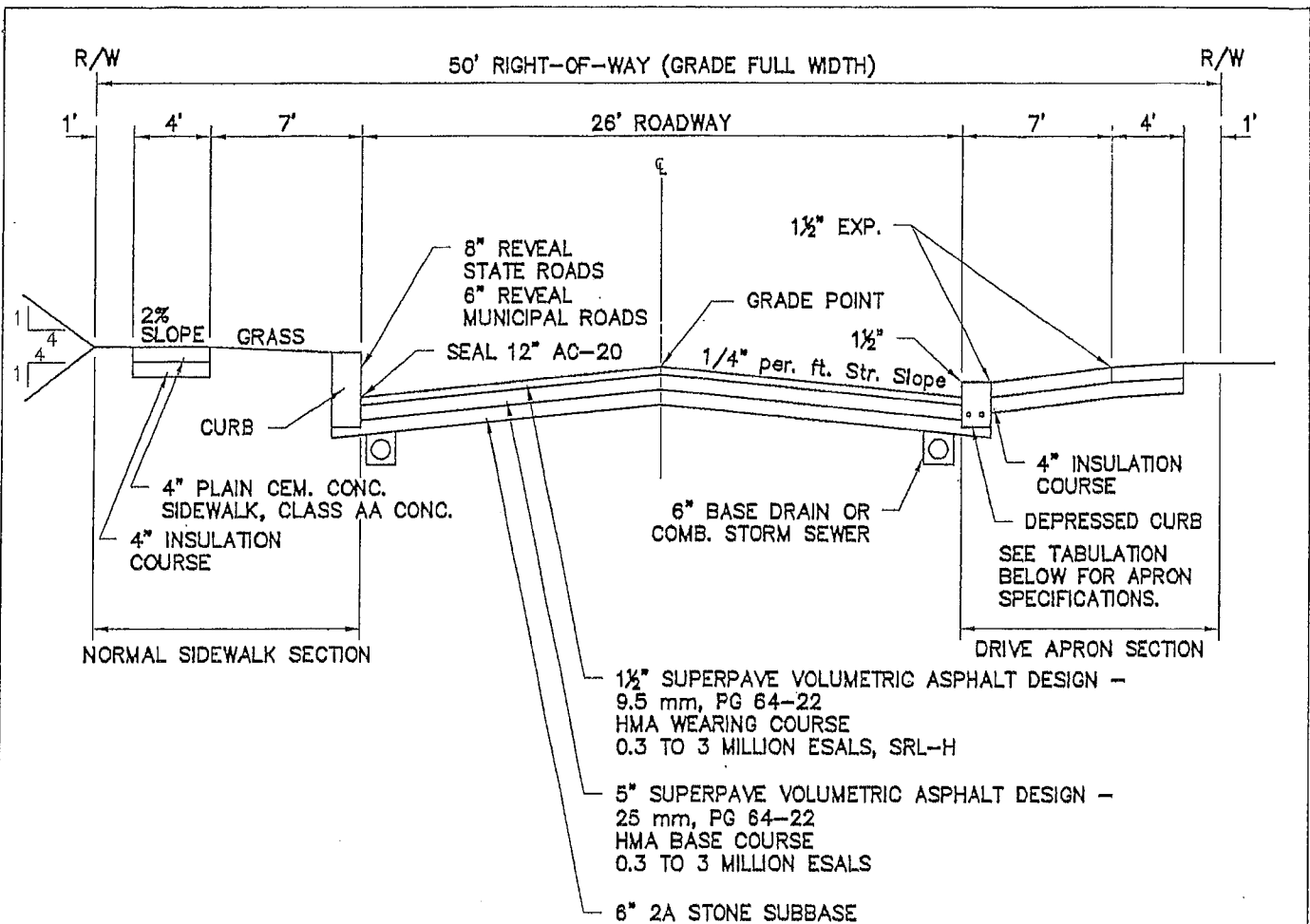

DRIVEWAY APRON SPECIFICATIONS

ZONE	PAVEMENT REQUIRED
RESIDENTIAL	6" REINF. CONC. PAV'T
COMMERCIAL	8" REINF. CONC. PAV'T
INDUSTRIAL	10" REINF. CONC. PAV'T

NOTES:

ALL CONSTRUCTION MATERIALS, METHODS OF CONSTRUCTION AND CONTROL OF WORK SHALL BE GOVERNED BY THE CURRENT EDITION OF PENNSYLVANIA DEPT. OF TRANSPORTATION SPECIFICATIONS PUBLICATION 408 AND STANDARDS OF ROADWAY CONSTRUCTION SERIES RC-1M TO 100M, ESPECIALLY RC-64M AND RC-67M FOR CURB RAMPS, SIDEWALKS AND DRIVEWAY APRONS. USE COMBINATION STORM SEWER AND UNDERDRAIN WHERE STORM SEWER IS PARALLEL TO CURB.

TYPICAL ROADWAY SECTION

LOCAL & SUB-COLLECTOR STREETS

26' ROADWAY

N.T.S.

NEWTOWN BOROUGH
JULY 2011

APPENDIX A

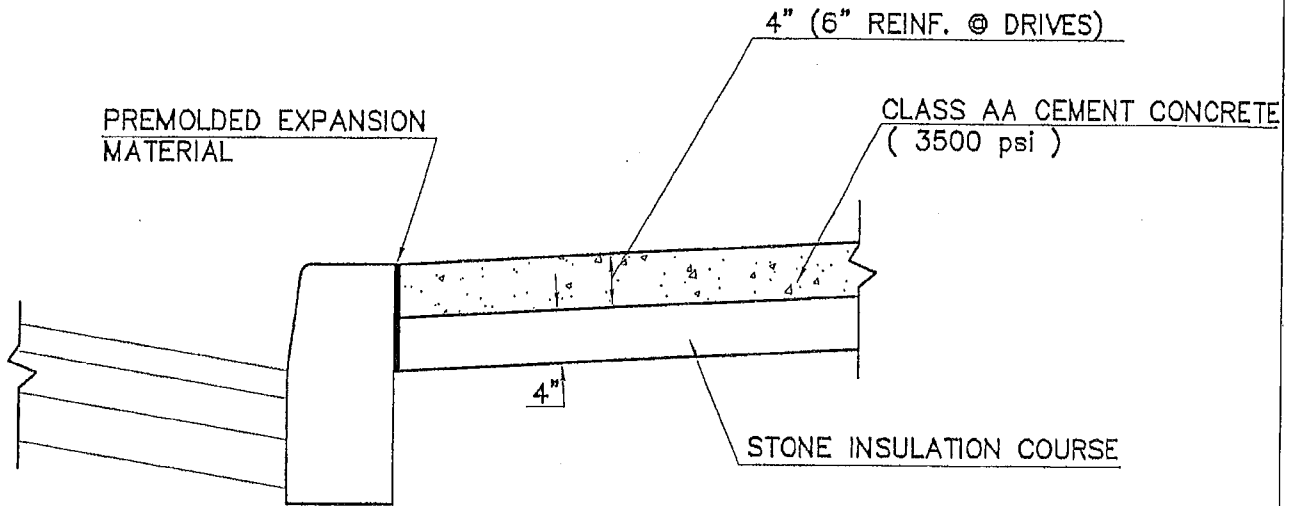

CEMENT CONCRETE SIDEWALK

N.T.S.

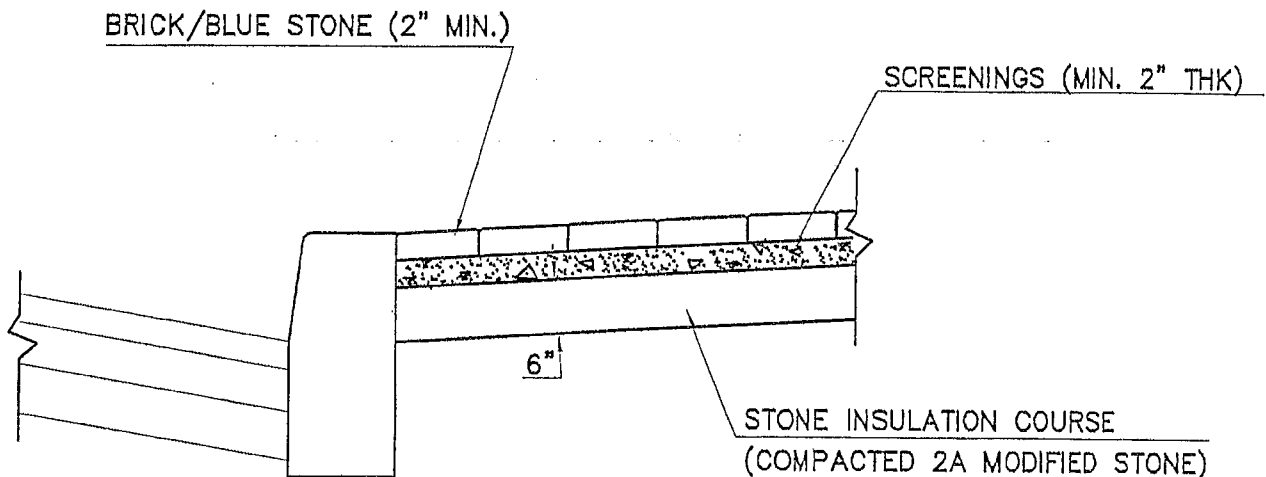

CLAY OR CONCRETE BRICK SIDEWALK
BLUE STONE SIDEWALK

N.T.S.

NOTES:

SIDEWALK SURFACE SHALL BE STABLE, FIRM AND SLIP RESISTANT IN ACCORDANCE WITH THE CURRENT ADA GUIDELINES. WHERE A SIDEWALK CROSSES A DRIVEWAY, THE SURFACE OF THE SIDEWALK SHALL BE CONTINUOUS ACROSS THE DRIVEWAY.

THE SIDEWALK SURFACE SHALL BE LEVEL. (SURFACE TO SURFACE ELEVATION DIFFERENCE OF $\frac{1}{4}$ " OR GREATER OR SHALL BE CORRECTED)

AT PEDESTRIAN STREET CROSSING POINTS, SIDEWALKS SHALL BE EXTENDED TO THE CURBLINE AND SHALL BE CONSTRUCTED WITH CURB RAMPS IN ACCORDANCE WITH ALL APPLICABLE PENNDOT AND ADA REQUIREMENTS AND SPECIFICATIONS.

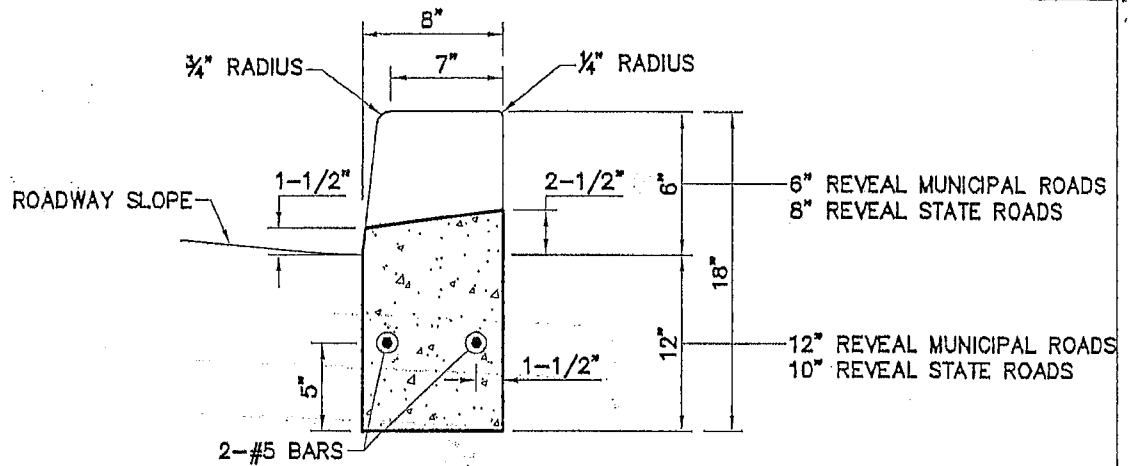

SECTION A-A

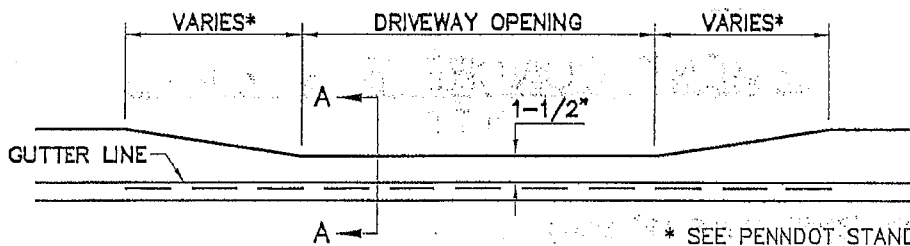

ELEVATION VIEW

* SEE PENNDOT STANDARDS FOR ROADWAY CONSTRUCTION RC64M AND 67M, CURRENT EDITION.

TYPICAL DEPRESSED CURB AT DRIVEWAY

N.T.S.

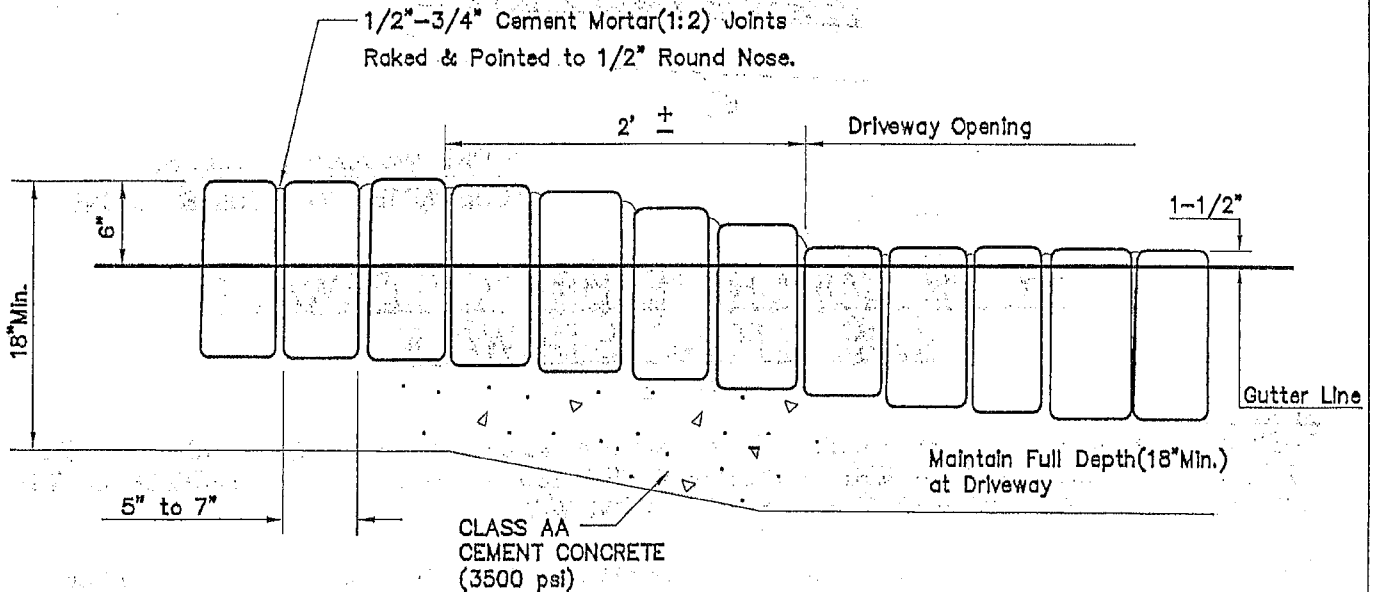

TYPICAL DEPRESSED CURB AT DRIVEWAY

(BELGIAN BLOCK, BLUESTONE, BROWNSTONE)

MUNICIPAL OR PRIVATE ROADS

N.T.S.

NEWTOWN BOROUGH
JULY 2011

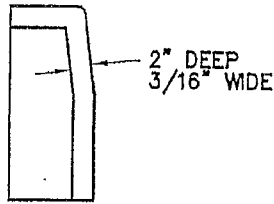

DETAIL A
CONTRACTION JOINT

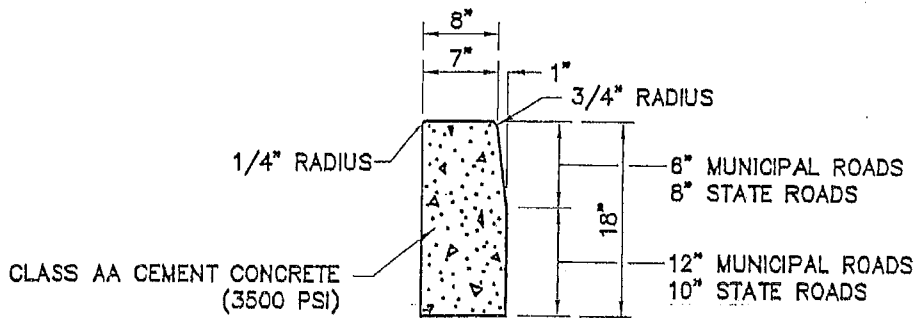

TYPICAL CROSS SECTION

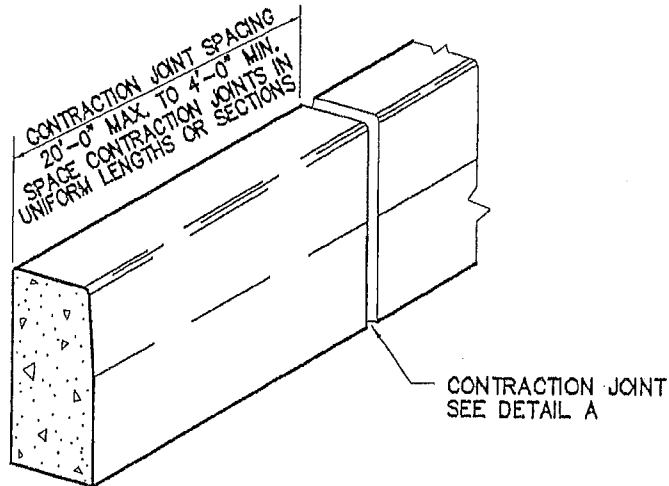

PLAIN CEMENT CONCRETE CURB
N.T.S.

Don't Let Storm Water Run Off With Your Time and Money!

What the Construction Industry Should Know About Storm Water In Our Community

The construction industry plays an important role in improving our community's quality of life by not only providing new development, but also protecting our streams and rivers through smart business practices that prevent pollution from leaving construction sites.

Storm water runoff leaving construction sites can carry pollutants such as dirt, construction debris, oil, and paint off-site and into storm drains. In our community, storm drains carry storm water runoff directly to local creeks, streams, and rivers with no treatment. Developers, contractors, and homebuilders can help to prevent storm water pollution by taking the following steps:

1. Comply with storm water permit requirements.
2. Practice erosion control and pollution prevention practices to keep construction sites "clean."
3. Conduct advanced planning and training to ensure proper implementation on-site.

The remainder of this fact sheet addresses these three steps.

Storm Water Permit Requirements for Construction Activity

Planning and permitting requirements exist for construction activities. These requirements are intended to minimize storm water pollutants leaving construction sites.

- Pennsylvania's Erosion and Sediment Pollution Control Program (25 Pa. Code, Chapter 102) requires Erosion and Sediment Control Plans for all earth disturbing activities.
- The National Pollutant Discharge Elimination System (NPDES) Permit Program (25 Pa. Code, Chapter 92) requires that construction activities disturbing greater than one acre submit a Notice of Intent for coverage under a general NPDES permit.

Knowing your requirements before starting a project and following them during construction can save you time and money, and demonstrate that you are a partner in improving our community's quality of life. For more information about these programs, contact your local county conservation district office or the Department of Environmental Protection.

What is Storm Water?

Storm water is water from precipitation that flows across the ground and pavement when it rains or when snow and ice melt. The water seeps into the ground or drains into what are commonly called storm sewers. These are the drains you see at street corners or at low points on the sides of streets. Collectively, the draining water is called **storm water runoff**.

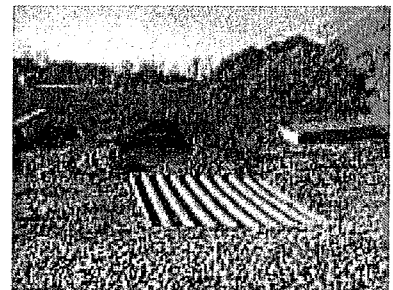

Erosion Control Practices:

- Perimeter controls (e.g. silt fence)
- Sediment traps
- Immediate revegetation
- Phased, minimized grading
- Construction entrance
- Protection of streams and drainage ways
- Inlet protection



An Ounce of Prevention

Rain that falls onto construction sites is likely to carry away soil particles and other toxic chemicals present on construction sites (oil, grease, hazardous wastes, fuel). Storm water, if not properly managed, carries these pollutants to streams, rivers, and lakes. Erosion and sediment control practices can serve as a first line of defense,

Pollution Prevention Practices:

- Designated fueling and vehicle maintenance area away from streams.
- Remove trash and litter.
- Clean up leaks immediately.
- Never wash down dirty pavement.
- Place dumpsters under cover.
- Dispose of all wastes properly.

minimizing clean up and maintenance costs, and the impacts to water resources caused by soil erosion during active construction. Erosion controls can reduce the volume of soil going into a sediment control device, such as a sediment trap, therefore, "clean out" frequencies are lower and maintenance costs are less. When possible, divert water around the construction site using berms or drainage ditches.

In addition, use pollution prevention and "good housekeeping measures" to reduce the pollution leaving construction sites as well. This can be as simple as minimizing the pollution source's contact with rainwater by covering it, maintaining a "clean site" by reducing trash and waste, and keeping vehicles well maintained.

The Best Laid Plans

Plans such as erosion and sediment control plans and storm water pollution prevention plans are important tools for outlining the erosion control and pollution prevention practices that you will use to manage storm water runoff prior to breaking ground. Developing good plans allows for proper budgeting and planning for the life of the project. Proper installation and maintenance of erosion and storm water controls is essential to a plan that works. Training for on-site staff helps to ensure the proper installation and maintenance of erosion controls and pollution prevention practices. Inspect controls and management techniques regularly to ensure they are working, especially after storm events. If polluted storm water is leaving the site, you may need to repair or add additional storm water controls.



The Bigger Storm Water Picture

Your community is preventing storm water pollution through a comprehensive storm water management program. This program addresses storm water pollution from construction, but it also deals with new development, illegal dumping to the storm sewer system, and municipal operations. It will also continue to educate the community and get everyone involved in making sure the only thing that storm water contributes to our streams is . . . water! Contact your community or the Pennsylvania Department of Environmental Protection for more information about storm water management.

For more information:

Pennsylvania Association of Conservation District's:
<http://www.pacd.org/default.html>

Pennsylvania Handbook of Best Management Practices for Developing Areas:
http://www.pacd.org/products/bmp/bmp_handbook.html

Storm Water Manager's Resource Center:
<http://www.stormwatercenter.net>

Pennsylvania Department of Environmental Protection:
<http://www.dep.state.pa.us>



Stormwater and the Construction Industry

Protect Natural Features



Bad

Minimize clearing.
 Maximize the amount of exposed soil.
 Reduce soil disturbance when cutting vegetation, such as trees, which will not be disturbed by construction activity.
Good

Protect existing stream banks with wood limbs, rock walls, or other methods to reduce erosion. Maintain a minimum distance of 10 feet between the edge of a stream and any disturbance or construction activity.

Construction Phasing

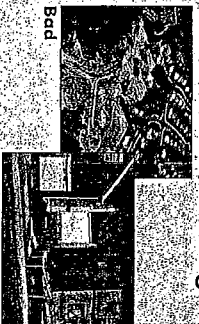

Bad

Schedule construction activities so that the soil is not exposed for long periods of time.
 Schedule or limit grading to small areas.
Good

Install key sediment control practices before site grading begins.
 Schedule site stabilization activities, such as seeding, to be completed immediately after the soil has been graded to its final contour.

Vegetative Buffers



Bad

Protect full length vegetative buffer along watercourses to help soil filter stormwater runoff.
Good

Plant and install vegetative buffer along watercourses to maintain buffer by mowing or replanting periodically to restore their effectiveness.

Silt Fencing

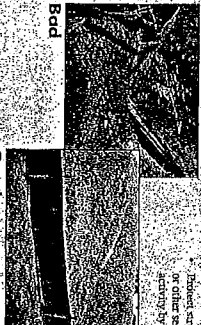

Bad

Inspect and maintain all silt fences after each rainstorm.
 Make sure the bottom of each silt fence is buried in the ground. Silt fences should be replaced as needed.
Good

Don't install silt fence in the middle of a structure, or near other exposed areas.
 Make sure silt fence is not being moved by wind, snow.

Site Stabilization



Bad

Apply seed, mulch, or other site stabilization practices to all areas of final disturbance as soon as possible.
Good

Maintain your BMPs!

www.epa.gov/nhpdas/memos/bmps

Construction Entrances

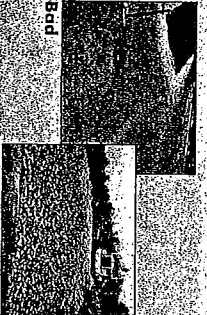

Bad

Remove silt and dirt from the site or construction vehicle before exiting the site.
Good

Use mats to prevent silt and dirt from being tracked onto public roads.
 Make sure the mat is clean and free of silt and dirt.
 Remove the mat after the vehicle has exited the site.

Slopes

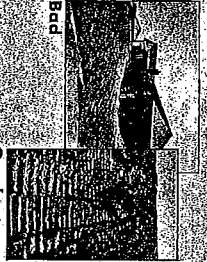

Bad

Stabilize exposed slopes.
Good

Apply seed, mulch, or other site stabilization practices to all areas of final disturbance as soon as possible.

Dirt Stockpiles



Bad

Stabilize exposed dirt stockpiles.
Good

Apply seed, mulch, or other site stabilization practices to all areas of final disturbance as soon as possible.

Storm Drain Inlet Protection

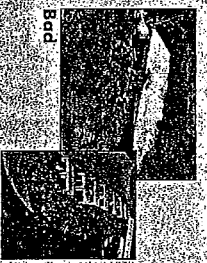

Bad

Install and maintain storm drain inlet protection.
Good

Install and maintain storm drain inlet protection to prevent silt and debris from entering the storm drain system.

